

RES-TEC
.....

2020

FLEXITEC

Multi-surface GRP roofing system

Application Datasheet:

Flexitec 2020 System direct to Kingspan
Thermaroom TR27 Insulation Boards

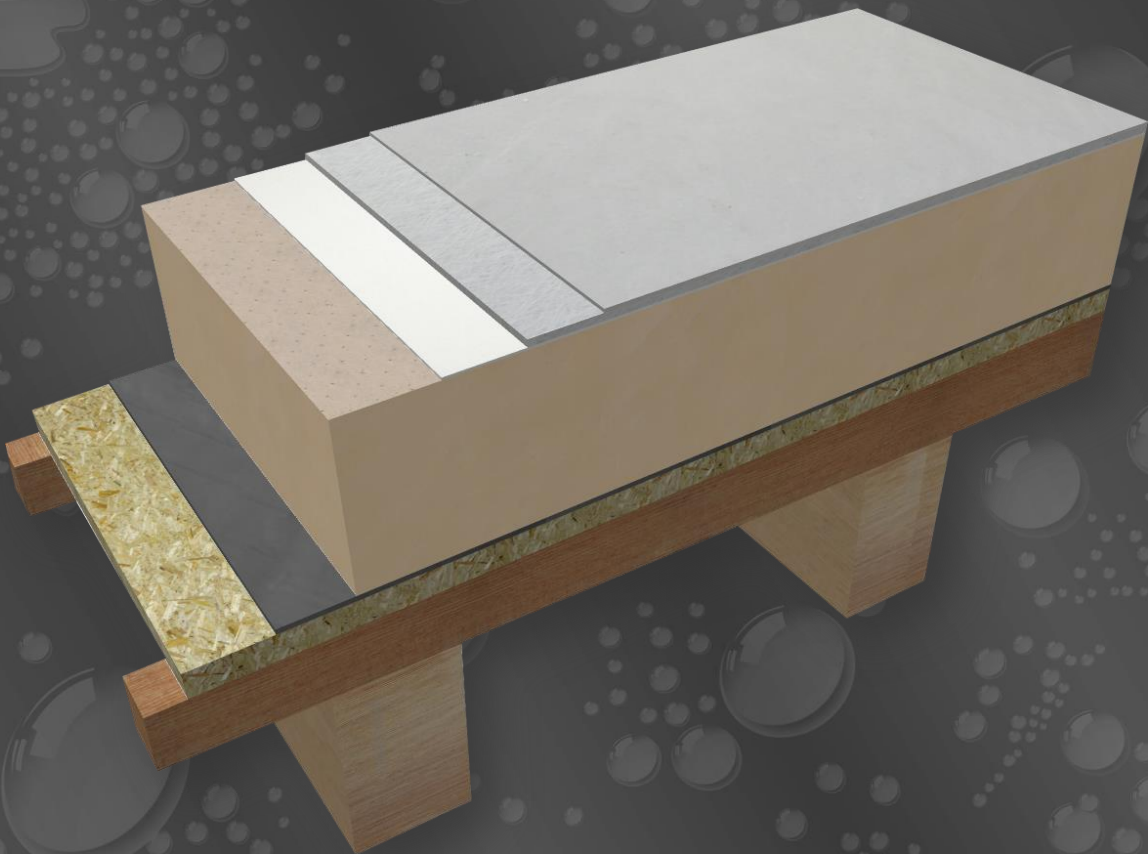

One resin. Countless possibilities.

Application Datasheet:

Flexitec 2020 Direct to Kingspan Thermaroom TR27 Insulation Boards

1. New Construction – Typical Timber Roof

1.1. Outline Roof Build-Up

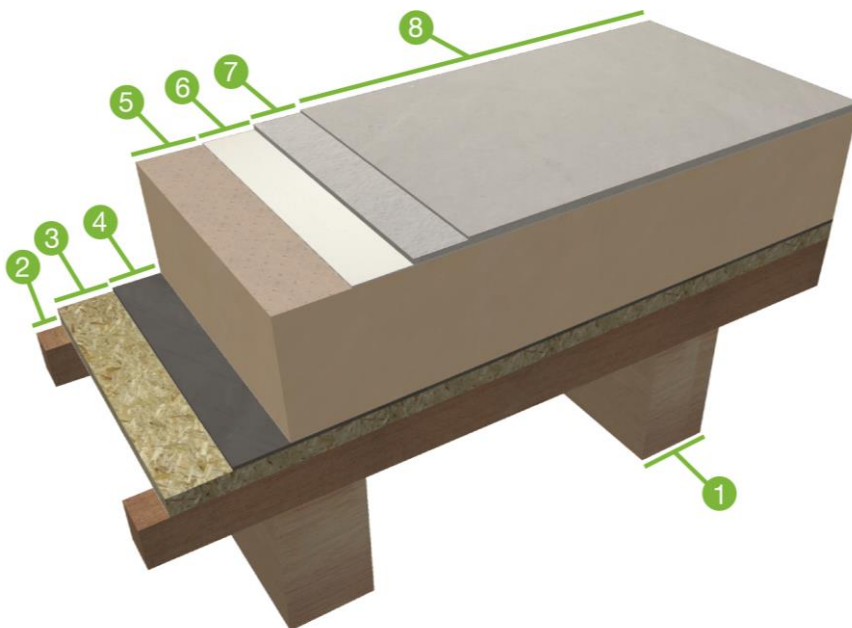

1. Timber joists at 400mm centres
2. Timber firrings (minimum 1 in 80 fall)
3. OSB3 spreadsheet
4. Vapour barrier (e.g. 1000 gauge Visqueen vapour barrier)
5. Kingspan Thermaroom TR27 Insulation
6. Flexitec 2020 Primer
7. 1st Coat Flexitec 2020 Light Grey* Resin with 225g/m² CSM fibreglass reinforcement
8. 2nd Coat Flexitec 2020 Light Grey* Resin

* Note – When applying direct to Kingspan Thermaroom TR27 Insulation the colour of Flexitec 2020 must be **Light Grey**. Any other colour, including Dark Grey, is not recommended.

1.2. Timber Firrings

Where required timber firrings are to be installed to create a minimum recommended 1 in 80 design fall using proprietary fixings applicable to the construction and environmental conditions.

1.3. OSB3 Spreadsheet

An 18mm OSB3 spreadsheet is to be mechanically fixed to the timber joists in accordance with the manufacturer's guidelines.

1.4. Timber Battens to Perimeters

Where appropriate timber supports should be fitted to all exposed perimeter edges as required using proprietary fixings applicable to the construction and environmental conditions.

1.5. Vapour Control Layer

Prior to laying the new vapour barrier surfaces should be smooth and level without voids or sharp protrusions and they should also be clean, dry and free from dust, frost or dew. A 1000 gauge Visqueen vapour control layer (or other suitable) is to be fitted and taped in accordance with the manufacturer's recommendations. The vapour control layer shall be continuous and encapsulate the insulation boards at abutments, penetrations and exposed edges.

1.6. Kingspan Thermarroof TR27 Insulation

Kingspan Thermarroof TR27 Insulation is to be mechanically fixed to the support structure of the roof strictly in accordance with the manufacturer's recommendations.

2. Flexitec 2020 System Application

2.1. Introduction

Refer to the Flexitec 2020 Application Manual for further details including suitable application conditions, powder hardener rates etc.

2.2. Flexitec 2020 Primer

Apply Flexitec 2020 Primer by roller at an approximate coverage rate of 4m²/Litre (3.5m²/kg). Allow to dry.

2.3. ResTrims

ResTrims should be mechanically fixed to perimeter timber support battens to form edge detailing. All joints should be reinforced with Flexitec 2020 Resin and 2 layers of Taping Mat. Allow to cure.

2.4. Roof Details

To any details requiring local reinforcement apply Flexitec 2020 Resin and Res-Tec Taping Mat. Allow to cure. NB: Apply 25mm dis-bondment tape to any joints subject to movement prior to application of local reinforcement.

2.5. Kingspan Thermarroof TR27 Insulation Board Joints

All insulation board joints are to be taped with Flexitec 2020 Resin and Taping Mat at a minimum coverage rate of 0.16Litres/linear metre (0.23kg/linear metre). Allow to cure. NB: As a guideline this equates to 0.25Litres (0.35kg) of Flexitec 2020 Resin used for every 1.0m² of roof area.

2.6. Flexitec 2020 First Coat Application

Apply 1st coat of Flexitec 2020 Resin at a minimum coverage rate of 0.85 – 1.0 Litres/m² (1.2 – 1.4kg/m²) and embed 225g/m² Res-Tec CSM fibreglass reinforcement. Allow to cure. NB: Coverage rates are indicative only and it is the installers' responsibility to ascertain the exact coverage rates on site.

2.7. Flexitec 2020 Second Coat Application

Apply 2nd coat of Flexitec 2020 Resin at a minimum coverage rate of 0.5Litres/m² (0.7kg/m²). Allow to cure.